

Folk Coatrack

Designed by Norm Architects for Design Within Reach

DESIGN
WITHIN
REACH

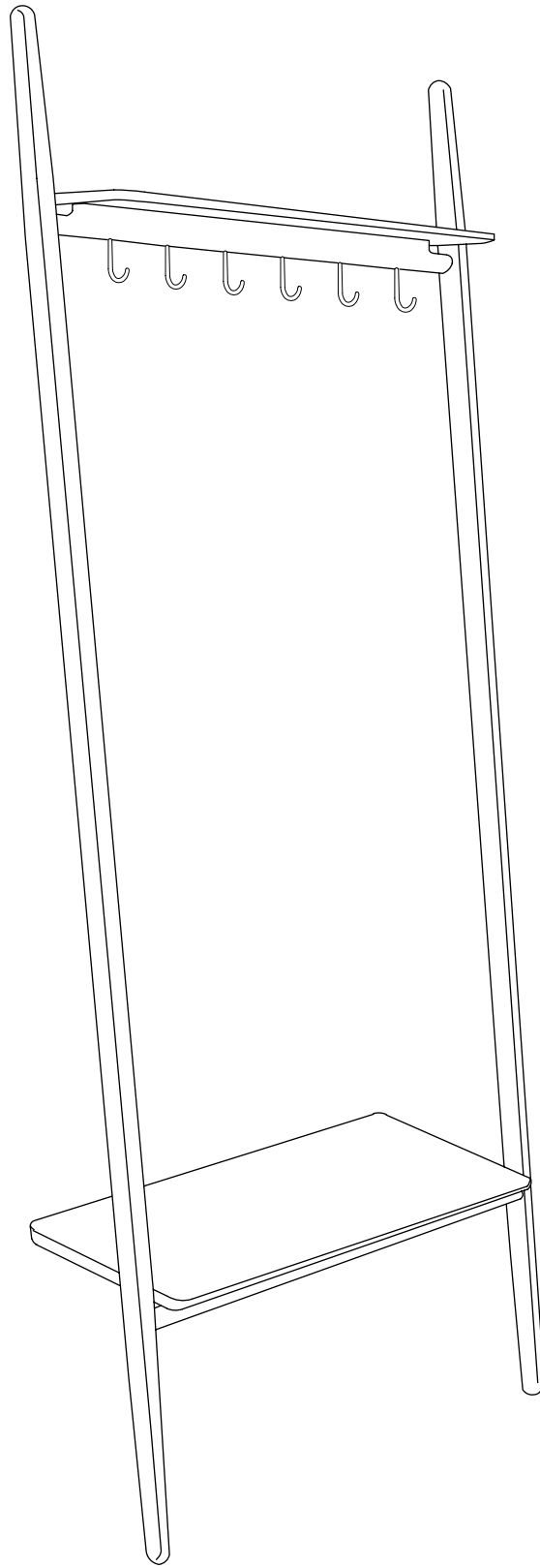

Customer Service:

1.800.944.2233 inside the U.S.

1.203.614.0600 outside the U.S.

For care instructions, please visit
dwr.com/learn.

Hardware Checklist

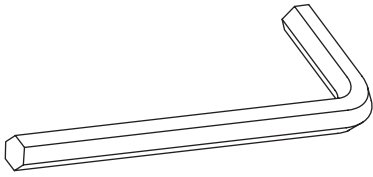

Allen wrench

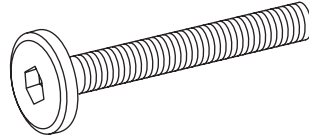

Bolt x 6
M6 x 50mm

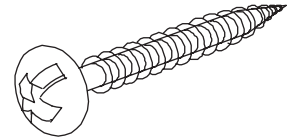

Anchor screw x 4
#10 x 3/4"



L-bracket x 2

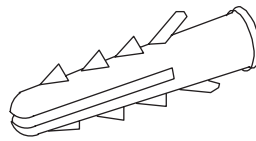

Wall anchor x 2
8mm x 30mm

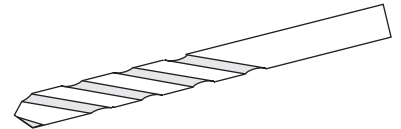

1/4" drill bit
(not included)

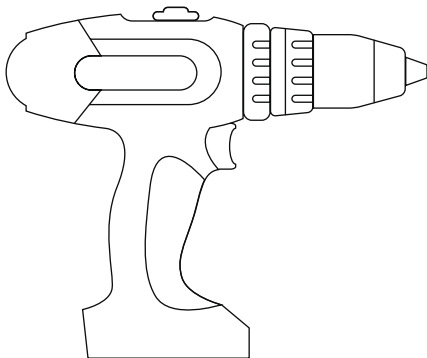

Electric drill
(not included)

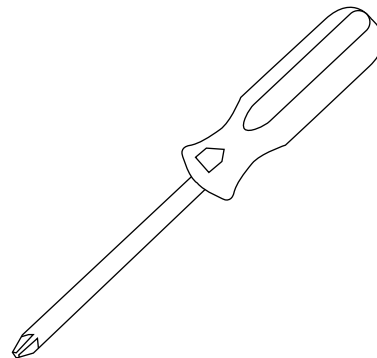

Phillips head screwdriver
(not included)

Folk Coatrack

1. Guide bottom shelf onto cross member as shown, aligning predrilled holes with preinstalled pegs. Install three bolts loosely at first, then tighten each gradually with Allen wrench until all are uniformly snug. Repeat with top shelf.

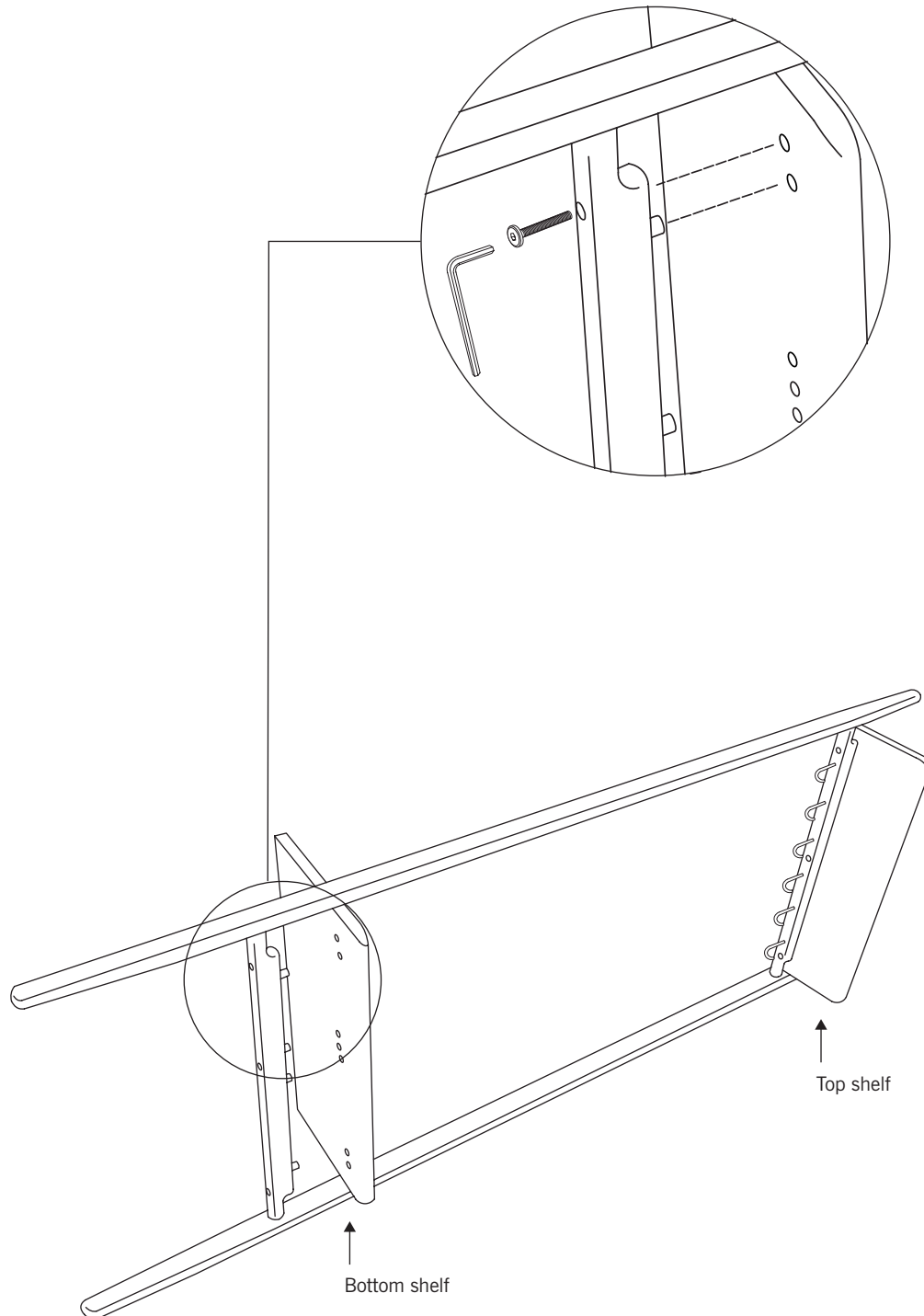

Folk Coatrack

2. Position coatrack in final location, making sure both shelves are tight to wall. Align L-bracket with predrilled hole on underside of top shelf. If possible, attach L-bracket to a stud behind wall surface, otherwise mark spot on wall through L-bracket hole to be drilled for installation of wall anchor. Remove L-bracket and set aside. Drill hole in wall with 3/8" bit and install wall anchor with gentle tap of hammer. Reposition L-bracket and install with one screw into wall and another into underside of shelf. Repeat with bottom shelf.

NOTE: Provided wall anchor is intended for use on drywall. For other wall materials, seek an appropriate fastener from a local supplier.

